



EMDAD
FOODS

Supply Chain Solutions



WAREHOUSING LOGISTICS DISTRIBUTION

3PL

YOUR FULFILLMENT LOGISTIC PARTNER

As a 3PL (Third party Logistics Provider), we at Emdad Logistics believe in supplying our customers with strategies to convert their supply chain needs and requirements into a receptive and cost-effective model. This means we can become your fulfillment logistic partner by providing outsourced end-to-end supply chain solutions that are efficiently aligned and tailored to your specific requirements.



OVERVIEW

Having been in the logistics industry for decades, during which time we have accumulated an enormous wealth of experience, we at Emdad are proud of our ability to deliver consistent, responsive, reliable and integrated storage services that satisfy our customers' needs. Knowing our customers, their business, and who their clients are enables us to target our services to benefit our clients within each of our 3 primary operating divisions:

3PL



Transportation
Move it



3PL Warehousing
Store it

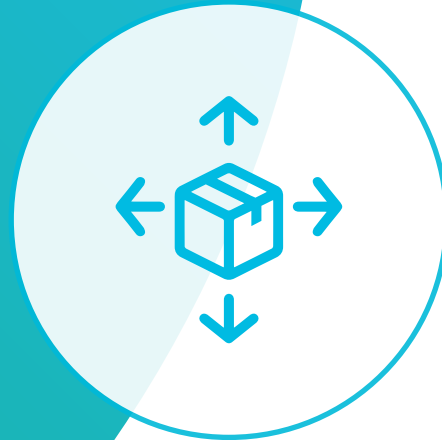

Packaging
Prepare it

A row of white commercial trucks, including box trucks and flatbed trucks, parked in front of a large industrial warehouse building. The scene is captured in a slightly desaturated, blue-tinted style. A large teal circle is overlaid on the left side of the image, containing the text 'OUR COMPANY CULTURE'.

OUR COMPANY CULTURE

Supported by our dedicated, professional team and our innovative logistics solutions, we aim to become your logistics and warehousing company of choice and thereby serve as an extension of your existing business projects, irrespective of their duration or size. Our core values are based around the delivery of trustworthy Warehousing, Distribution, and Logistics solutions to all types of business owners in accordance with their needs and requirements.

An aerial photograph of an industrial park or business district. The foreground shows a large, modern industrial building with a flat roof. The middle ground is filled with numerous other industrial buildings of various sizes, interspersed with parking lots and some greenery. In the background, a range of rugged, brown mountains stretches across the horizon under a clear sky. On the left side of the image, there are several white, curved, abstract lines that resemble a stylized flame or a leaf.

OUR LOCATION

“
Strategically
Located For Business
Advantages
”

Muscat, AlRusayl Logistic Area

Our customers are our highest priority; therefore, it is essential to locate our logistic chain network strategically to ensure we meet their cross-border transport needs in a timely fashion and in line with their expectations and standards.

To that end, we have located our facilities in Oman immediately adjacent to Muscat's highway, major ports such as Muscat International Airport, and other primary road links.

Warehouses to Airport:
19 min (25km)

Warehouse to Port:
Sohar Port (230 km)

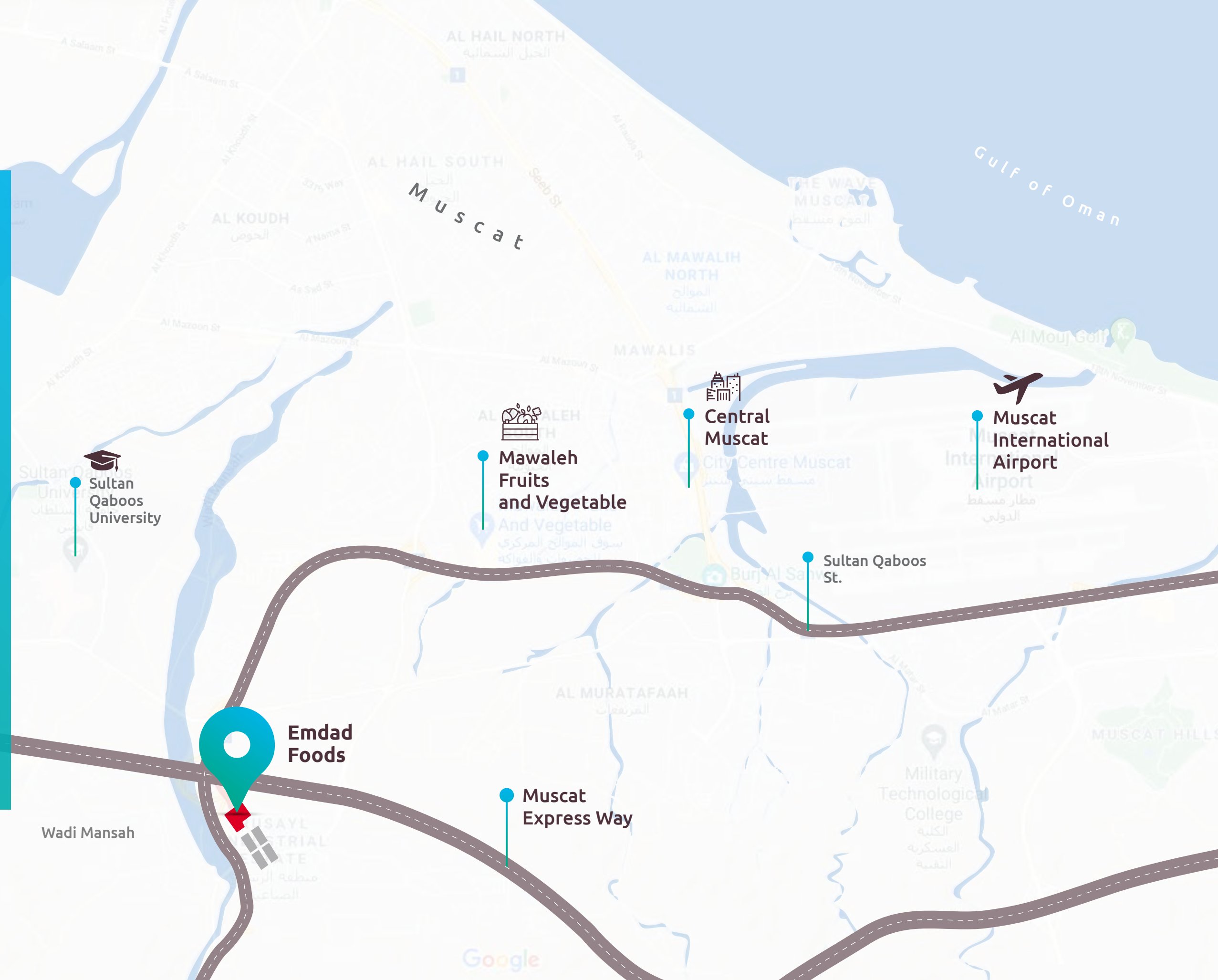



A LOGISTIC
LIFECYCLE

••
Dedicated.
Prominent.
Reliable

We offer a broad range of services at Emdad Logistic Center with customer satisfaction guaranteed. These services range from physical warehousing to logistics, stock management, and distribution. Through the support of a smooth and convenient logistic lifecycle, our overriding aim is to assist businesses so that they can expand and thrive in an extremely competitive business environment.

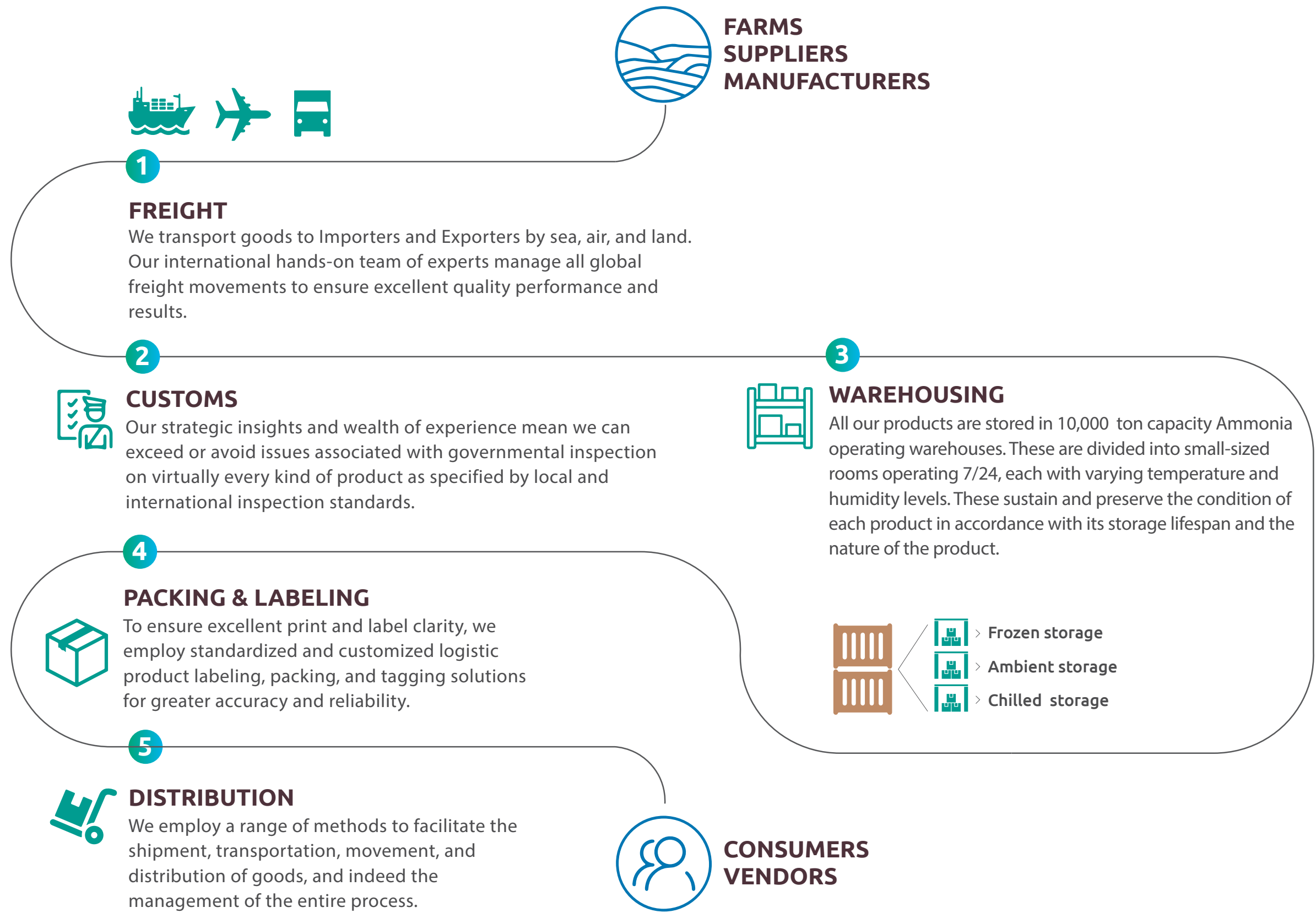



Our Versatile Solutions

“
With Us As Your Fulfillment Partner, You Can Pick, Mix, and Match What You Are Looking For:
”

1



Specialized commercial distribution and transportation.

2



Shipping and customs clearance.

3



Inventory Management.

4



Cooling and warehousing.



MOVE IT



We have the proficiency and a wide range of reliable networks



AN AUTHORIZED TIR TRANSPORTER

Our status as an authorized TIR transporter means we have the capability to compromise, ease, and simplify administrative procedures associated with international cross-border road transport.



FREIGHT FORWARDING: ***SEA, AIR, LAND***

- Commercial Shipments
- Exports by Air/Sea/Road
- Export Packaging
- Imports Air/Sea/Road
- Import Customs Clearance in to OMAN
- Full Load Cargo (FCL)/ Groupage (LCL)
- Collection and Delivery Nationwide

Distribution:

Due to our ideal location in Muscat, Oman, we can transport goods to Importers and Exporters across the world using all modes of transport (Sea, Air and Land). Such services are enhanced by our strong relationship with the most outstanding companies in the logistic industry, including Maersk, APL, CMA CGM, and Hapag-Lloyd. Acting on your behalf, our global hands-on team of experts will handle freight movements across the world to ensure excellent quality performance and results. Our strategic insights and wealth of experience mean we can exceed or even avoid issues associated with governmental inspection on virtually every kind of product as specified by local and international inspection standards





STORE IT

Shouldn't Your Warehousing Partner
Be as Valuable as the Quality
of The Food You Supply ?





OUR LESS
IS MORE

In our role as a leading comprehensive 3PL company, we provide a vital connection between the producer, the processor, the vendor, and ultimately the consumer.

Being the biggest warehousing in Oman, Our **10,000** ton capacity Ammonia operating warehouses are separated into **24/7** operating small-sized rooms, each with varying levels of temperature and humidity. These serve to sustain and preserve the condition of each product in accordance with its storage lifespan and the nature of the product.

To continue operating, our dedicated warehousing and storage facilities are subjected to frequent and scrupulous assessments and adhere to all relevant sanitation and hygiene rules and procedures.



OUR
STORAGE
**SAFETY
COMES
FIRST**

One of our leading priorities and concerns has always been the storage of products. The length of time we have been in the storage industry means we fully understand the importance of investing in technological systems to ensure we perform our job correctly.

Our advanced monitoring systems allow us to remotely monitor, tailor, and adjust the temperature of each our storage units. We can therefore guarantee that all your products are continually stored at constant, safe temperature ranges in accordance with the desired specifications and storage requirements for each product. Care is also taken to monitor all service doors within our facilities (when they are opened and closed) as well as the drop-off areas for trucks.



OUR
STORAGE
SAFETY
COMES
FIRST

The increasing availability of innovative technologies means we are able to invest in increasingly sophisticated and updated systems. This will ensure we become a market leader in the storage of products and fulfil our clientele's safety and health needs and requirements in accordance with international standards and regulations.





WAREHOUSING TYPES

The facilities comprise dedicated temperature-controlled storage solutions, details of which are as follows:



Ambient Storage:

Our ambient storage facilities are designed for any “dry” product with a long shelf life that can be stored at room temperature in an environment free of moisture and humidity.

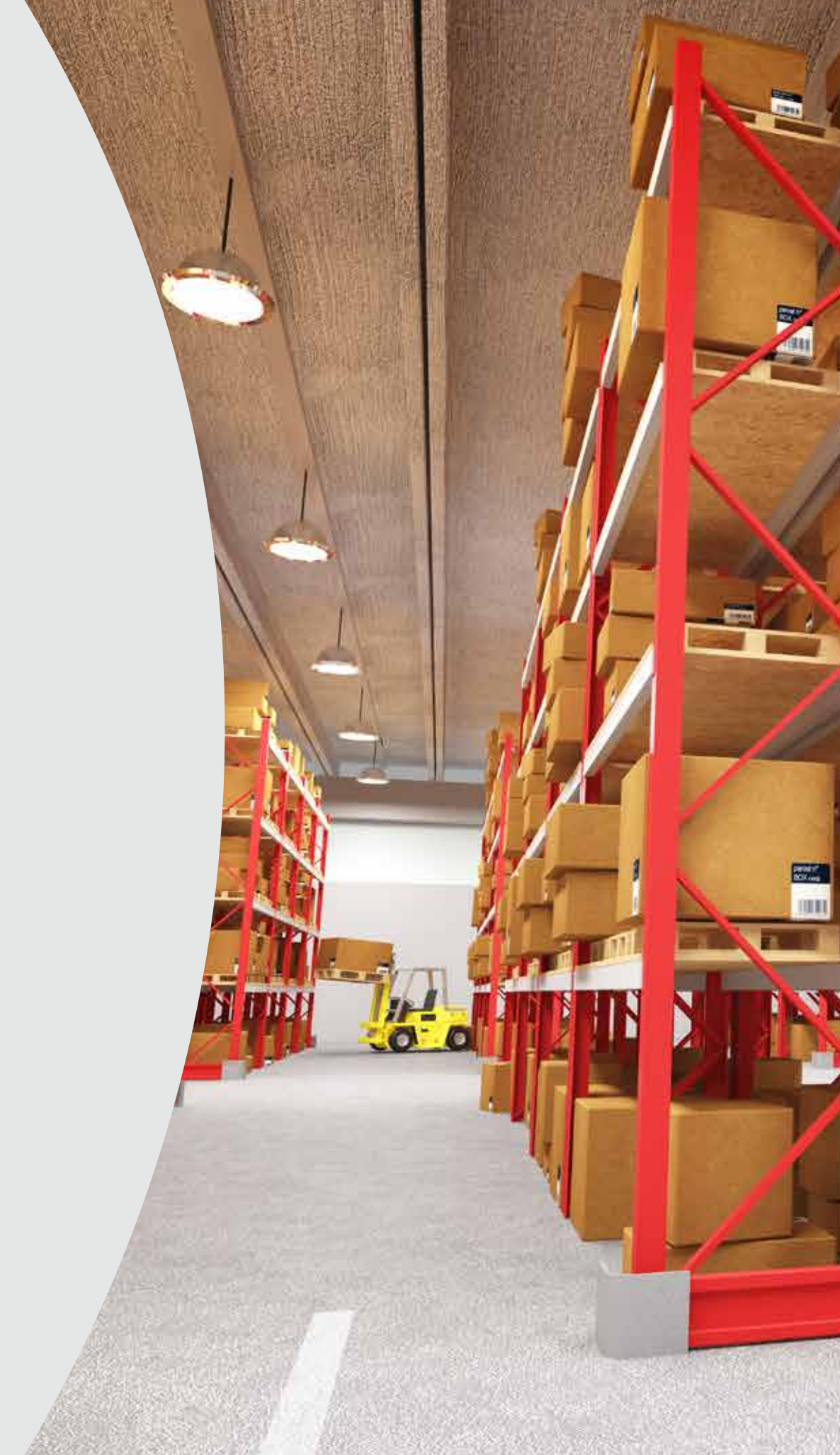



WAREHOUSING TYPES

The facilities comprise dedicated temperature-controlled storage solutions, details of which are as follows:

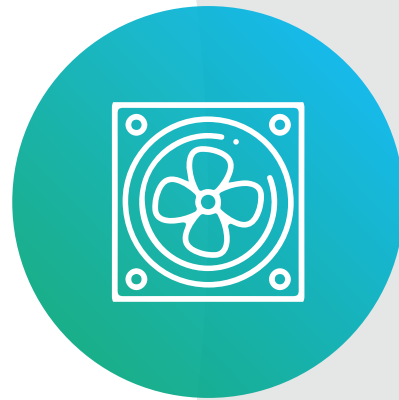

Chilled Storage:

The ideal cold or refrigerated storage spaces required by importers and exporters of temperature-sensitive goods are provided by our temperature-controlled warehouse facilities. These spaces contain specialized cooling and refrigerating systems suitable for different products.





WAREHOUSING TYPES

The facilities comprise dedicated temperature-controlled storage solutions, details of which are as follows:



Frozen Storage:

Our temperature-controlled storage facilities enable us to provide optimum freezer warehousing services comprising regulated freezer storage rooms.



WAREHOUSING TAKEN TO THE NEXT LEVEL

1



By pre-cooling products to their optimum temperature prior to being loaded onto containers, we guarantee their quality. Precooling measures are also applied to the containers to prevent any surface defrosting or freeze burns.

2



Among the various options provided by blast freezing storage solutions is the rapid cold shock technique. This is used to bring the temperature of products down extremely quickly prior to storing them at the room temperature required for long-lasting storage (depending on the product).

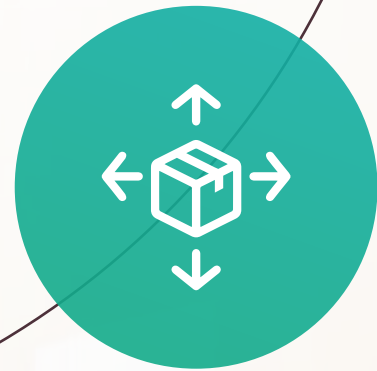

PREPARE IT



Comprehensive and integrated
Packaging and
Labelling experience



PACKAGING AND LABELLING SOLUTIONS

Irrespective of the products being shipped and/or stored, or the conditions they are in, our customized and standardized product labeling, packing, and tagging solutions will fulfil the needs and requirements of all our clients by ensuring outstanding clarity of printing and labels in the following preparation categories:

- Product labeling
- Product barcoding
- Price tagging
- Retail consolidation (Multi-vendor)
- Foiling & netting
- Bagging, cartonizing
- Re-packing

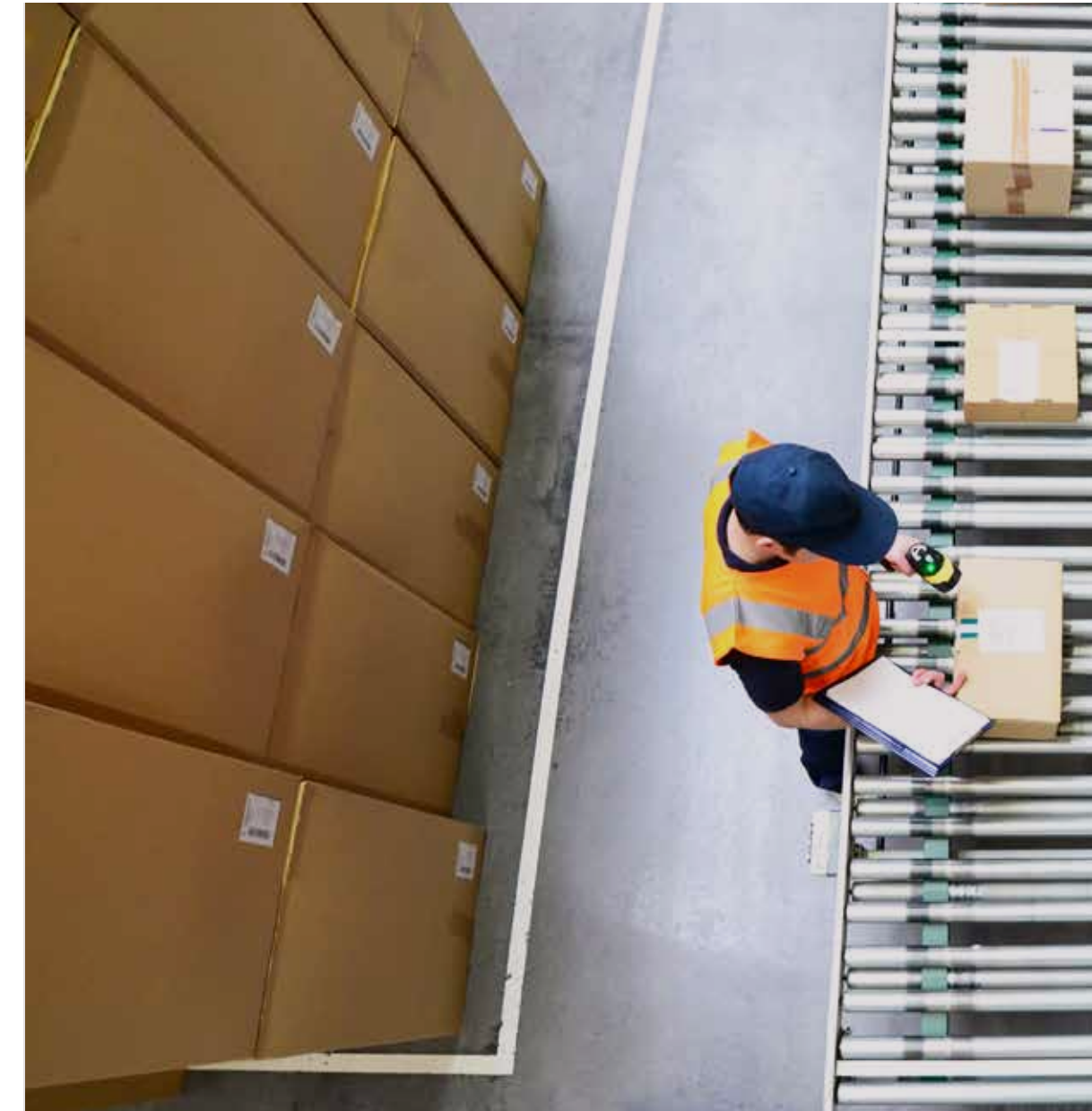



WAREHOUSE PLANS

MASTER PLAN



Muscat Expressway

Muscat Expressway

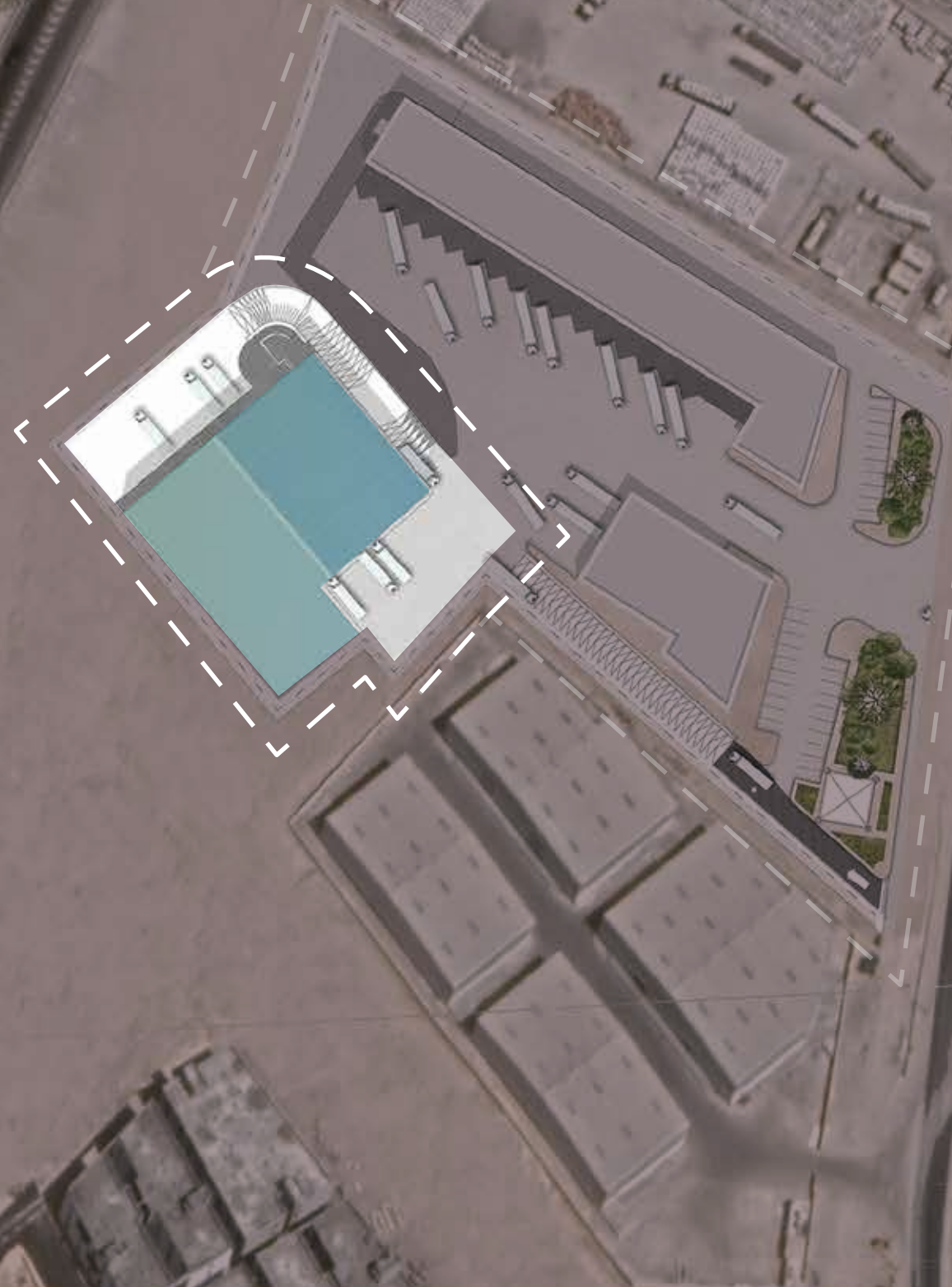

PHASE 1

The first phase of our facility will comprise a 7500 m² multi-functional logistic warehouse containing food storage units furnished with the most advanced cold storage systems.

MASTER PLAN



Muscat Expressway

Muscat Expressway



PHASE 2

In the coming years, our goal is to provide a comprehensive logistic experience by enhancing our services further. This will be achieved through an expansion of our warehousing footprint and extending the functions and services we provide with a total footprint of 21,000 m².

OUR MULTI-FUNCTIONAL LOGISTICS
WAREHOUSE WILL START RUNNING
REALLY SOON!



THE COUNTDOWN
BEGINS

GROUND FLOOR PLAN

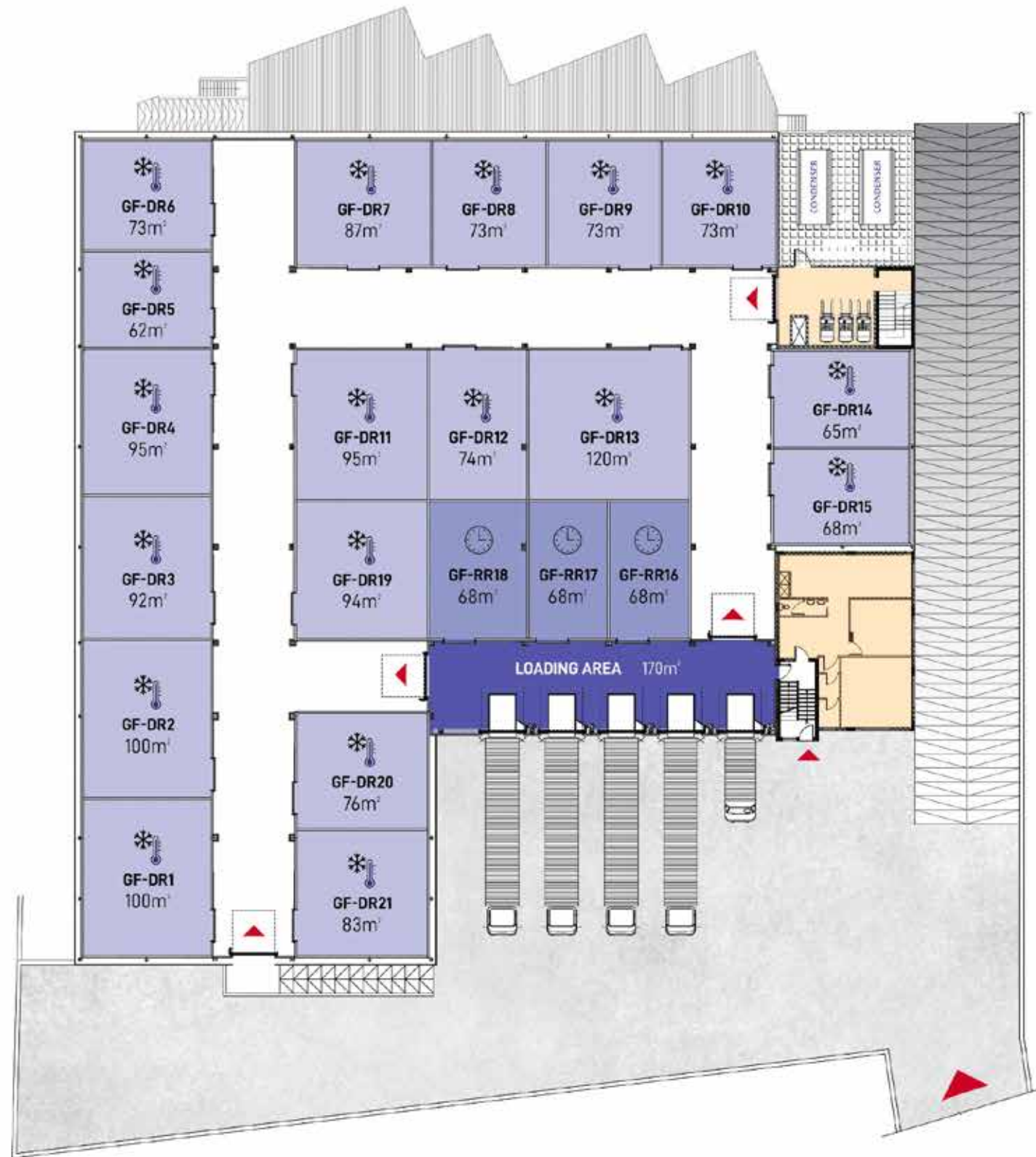

GROUND FLOOR DETAILS

UNIT	FUNCTION	AREA	DIMENSIONS	TEMP.
GF-DR1	DOUBLE REGIME ROOM	100 m ²	9.08W x 11.14L x 9.45H	±0 °C / -20°C
GF-DR2	DOUBLE REGIME ROOM	100 m ²	9.08W x 11.25L x 9.45H	±0 °C / -20°C
GF-DR3	DOUBLE REGIME ROOM	92 m ²	9.08W x 10.10L x 9.45H	±0 °C / -20°C
GF-DR4	DOUBLE REGIME ROOM	95 m ²	9.08W x 10.35L x 9.45H	±0 °C / -20°C
GF-DR5	DOUBLE REGIME ROOM	62 m ²	9.08W x 6.83L x 9.45H	±0 °C / -20°C
GF-DR6	DOUBLE REGIME ROOM	73 m ²	9.08W x 7.77L x 9.45H	±0 °C / -20°C
GF-DR7	DOUBLE REGIME ROOM	87 m ²	9.58W x 8.93L x 9.45H	±0 °C / -20°C
GF-DR8	DOUBLE REGIME ROOM	73 m ²	8.10W x 8.93L x 9.45H	±0 °C / -20°C
GF-DR9	DOUBLE REGIME ROOM	73 m ²	8.00W x 8.93L x 9.45H	±0 °C / -20°C
GF-DR10	DOUBLE REGIME ROOM	73 m ²	8.13W x 8.93L x 9.45H	±0 °C / -20°C
GF-DR11	DOUBLE REGIME ROOM	95 m ²	9.37W x 10.67L x 9.45H	±0 °C / -20°C
GF-DR12	DOUBLE REGIME ROOM	74 m ²	6.96W x 10.67L x 9.45H	±0 °C / -20°C
GF-DR13	DOUBLE REGIME ROOM	120 m ²	11.42W x 10.67L x 9.45H	±0 °C / -20°C
GF-DR14	DOUBLE REGIME ROOM	65 m ²	9.68W x 6.84L x 9.45H	±0 °C / -20°C
GF-DR15	DOUBLE REGIME ROOM	68 m ²	9.68W x 6.73L x 9.45H	±0 °C / -20°C
GF-RR16	REOPENING ROOM	68 m ²	5.66W x 9.80L x 9.45H	±0 °C / 12°C
GF-RR17	REOPENING ROOM	68 m ²	5.61W x 9.80L x 9.45H	±0 °C / 12°C
GF-RR18	REOPENING ROOM	68 m ²	6.96W x 9.80L x 9.45H	±0 °C / 12°C
GF-DR19	DOUBLE REGIME ROOM	94 m ²	9.37W x 9.80L x 9.45H	±0 °C / -20°C
GF-DR20	DOUBLE REGIME ROOM	76 m ²	9.31W x 8.20L x 9.45H	±0 °C / -20°C
GF-DR21	DOUBLE REGIME ROOM	83 m ²	9.31W x 8.93L x 9.45H	±0 °C / -20°C
GF-LA25	LOADING AREA	170 m ²	23.62W x 6.54L x 6H	+10°C

Plan Legend:



BASEMENT FLOOR PLAN



BASEMENT FLOOR PLAN

UNIT	FUNCTION	AREA	DIMENSIONS	TEMP.
BSM-DR1	DOUBLE REGIME ROOM	98 m ²	8.89W x 11.12L x 6H	±0 °C / -20°C
BSM-DR2	DOUBLE REGIME ROOM	98 m ²	8.89W x 11.05L x 6H	±0 °C / -20°C
BSM-DR3	DOUBLE REGIME ROOM	88 m ²	8.89W x 9.90L x 6H	±0 °C / -20°C
BSM-DR4	DOUBLE REGIME ROOM	88 m ²	8.89W x 9.90L x 6H	±0 °C / -20°C
BSM-DR5	DOUBLE REGIME ROOM	68 m ²	8.89W x 7.68L x 6H	±0 °C / -20°C
BSM-DR6	DOUBLE REGIME ROOM	68 m ²	8.89W x 7.75L x 6H	±0 °C / -20°C
BSM-DR7	DOUBLE REGIME ROOM	118 m ²	8.88W x 13.28L x 6H	±0 °C / -20°C
BSM-DR8	DOUBLE REGIME ROOM	118 m ²	8.88W x 13.27L x 6H	±0 °C / -20°C
BSM-DR9	DOUBLE REGIME ROOM	125 m ²	8.88W x 14.05L x 6H	±0 °C / -20°C
BSM-DR10	DOUBLE REGIME ROOM	70 m ²	8.88W x 7.95L x 6H	±0 °C / -20°C
BSM-DR11	DOUBLE REGIME ROOM	80 m ²	8.88W x 7.95L x 6H	±0 °C / -20°C
BSM-DR12	DOUBLE REGIME ROOM	65 m ²	8.14W x 8.05L x 6H	±0 °C / -20°C
BSM-DR13	DOUBLE REGIME ROOM	65 m ²	8.04W x 8.05L x 6H	±0 °C / -20°C
BSM-PR14	PEANUT ROOM	52 m ²	9.45W x 5.53L x 3H	±0 °C / +4°C
BSM-PR16	PROCESSING AREA	680 m ²	24.63W x 33.26L x 6H	+20°C
BSM-PR17	PACKAGING AREA	200 m ²	24.63W x 8.80L x 4.5H	+10°C
BSM-LA18	LOADING AREA	200 m ²	4.5H	+10°C

Plan Legend:





FACILITY AMENITIES



Safe Storage
& Warehousing Spaces



Offices



Comfortable Working
Environments



Parking
Lots



WAREHOUSE FEATURES



Monitoring & Security
Devices



Dry & Cooled
Tankers Fleet

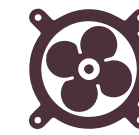

High-Efficiency
Coolers



Use Of Central
Ammonia System



Qualified Staff
& Experts



Practical Shelving
System

OUR KEY CLIENTS

Over the years, we have been building trusting relationships with our clients and partners that are diversified across different businesses and organizations. We would like to thank our key clients for their continued support, confidence and trust in Emdad Logistics to service their business needs.

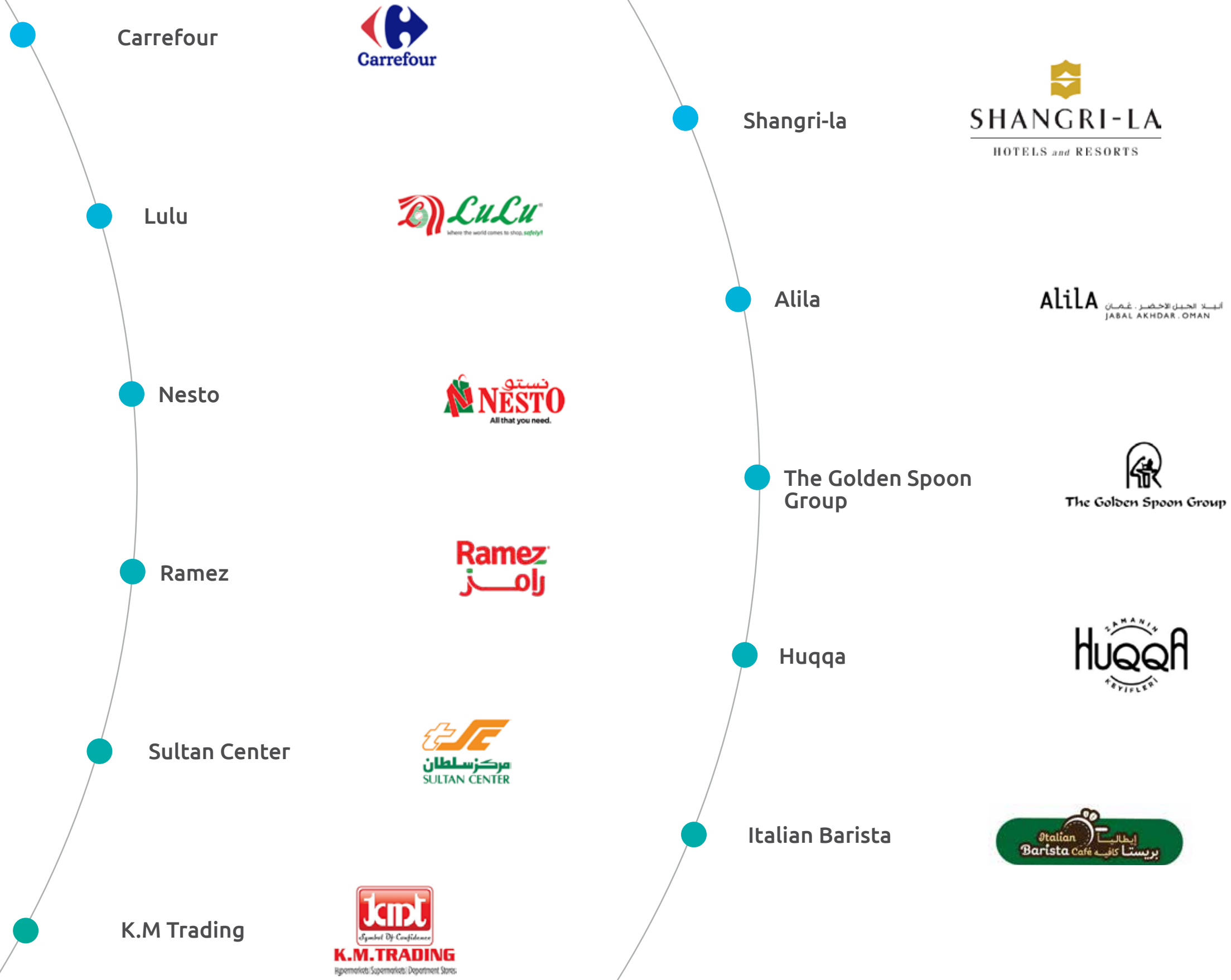

OUR KEY CLIENTS

Over the years, we have been building trusting relationships with our clients and partners that are diversified across different businesses and organizations. We would like to thank our key clients for their continued support , confidence and trust in Emdad Logistics to service their business needs.

Oig



S.J.Abed &
Al Sulaimi Catering
Group



Suhol Al Fayha
Trading



Como



Adic



Sultan Center



Al Nur



CCC



Al Tasnim



Ambition
Unlimited



BTA





EMDAD
FOODS

THANK YOU

شركة النور لتطوير المشاريع
AlNur Projects Development Co.

Tel: +968 24 446 663
Fax: +968 24 536 582

Email: info@emdadfoods.com
www.emdadfoods.com

P.O.Box: 706, P.C.: 111, SEEB
Muscat, Sultanate of Oman