



WAREHOUSE PLANS

MASTER PLAN



Muscat Expressway

Muscat Expressway

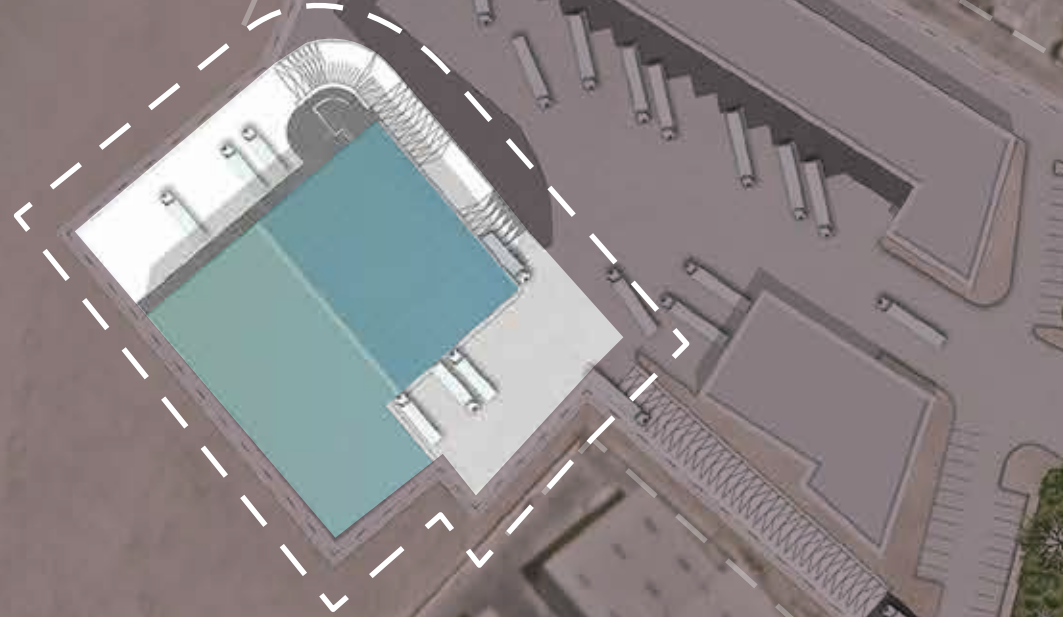

OPENING 2021

The first phase of our facility will be completed in 2021. This will comprise a multi-functional logistic warehouse containing food storage units furnished with the most advanced cold storage systems.

MASTER PLAN



Muscat Expressway

Muscat Expressway



PHASE 2

In the coming years, our goal is to provide a comprehensive logistic experience by enhancing our services further. This will be achieved through an expansion of our warehousing footprint and extending the functions and services we provide.

GROUND FLOOR PLAN

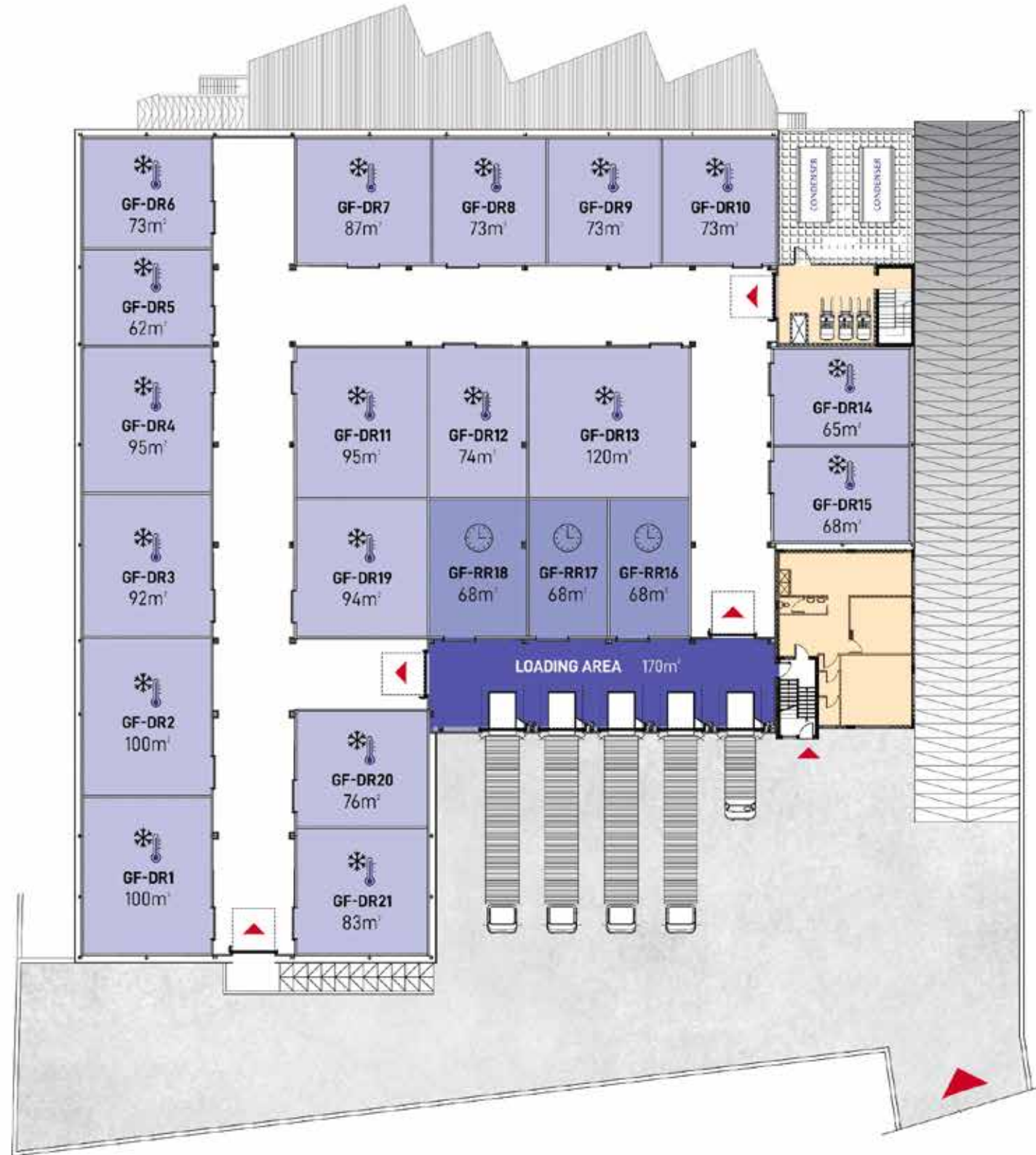

GROUND FLOOR DETAILS

UNIT	FUNCTION	AREA	DIMENSIONS	TEMP.
GF-DR1	DOUBLE REGIME ROOM	100 m ²	9.08W x 11.14L x 9.45H	±0 °C / -20°C
GF-DR2	DOUBLE REGIME ROOM	100 m ²	9.08W x 11.25L x 9.45H	±0 °C / -20°C
GF-DR3	DOUBLE REGIME ROOM	92 m ²	9.08W x 10.10L x 9.45H	±0 °C / -20°C
GF-DR4	DOUBLE REGIME ROOM	95 m ²	9.08W x 10.35L x 9.45H	±0 °C / -20°C
GF-DR5	DOUBLE REGIME ROOM	62 m ²	9.08W x 6.83L x 9.45H	±0 °C / -20°C
GF-DR6	DOUBLE REGIME ROOM	73 m ²	9.08W x 7.77L x 9.45H	±0 °C / -20°C
GF-DR7	DOUBLE REGIME ROOM	87 m ²	9.58W x 8.93L x 9.45H	±0 °C / -20°C
GF-DR8	DOUBLE REGIME ROOM	73 m ²	8.10W x 8.93L x 9.45H	±0 °C / -20°C
GF-DR9	DOUBLE REGIME ROOM	73 m ²	8.00W x 8.93L x 9.45H	±0 °C / -20°C
GF-DR10	DOUBLE REGIME ROOM	73 m ²	8.13W x 8.93L x 9.45H	±0 °C / -20°C
GF-DR11	DOUBLE REGIME ROOM	95 m ²	9.37W x 10.67L x 9.45H	±0 °C / -20°C
GF-DR12	DOUBLE REGIME ROOM	74 m ²	6.96W x 10.67L x 9.45H	±0 °C / -20°C
GF-DR13	DOUBLE REGIME ROOM	120 m ²	11.42W x 10.67L x 9.45H	±0 °C / -20°C
GF-DR14	DOUBLE REGIME ROOM	65 m ²	9.68W x 6.84L x 9.45H	±0 °C / -20°C
GF-DR15	DOUBLE REGIME ROOM	68 m ²	9.68W x 6.73L x 9.45H	±0 °C / -20°C
GF-RR16	REOPENING ROOM	68 m ²	5.66W x 9.80L x 9.45H	±0 °C / 12°C
GF-RR17	REOPENING ROOM	68 m ²	5.61W x 9.80L x 9.45H	±0 °C / 12°C
GF-RR18	REOPENING ROOM	68 m ²	6.96W x 9.80L x 9.45H	±0 °C / 12°C
GF-DR19	DOUBLE REGIME ROOM	94 m ²	9.37W x 9.80L x 9.45H	±0 °C / -20°C
GF-DR20	DOUBLE REGIME ROOM	76 m ²	9.31W x 8.20L x 9.45H	±0 °C / -20°C
GF-DR21	DOUBLE REGIME ROOM	83 m ²	9.31W x 8.93L x 9.45H	±0 °C / -20°C
GF-LA25	LOADING AREA	170 m ²	23.62W x 6.54L x 6H	+10°C

Plan Legend:

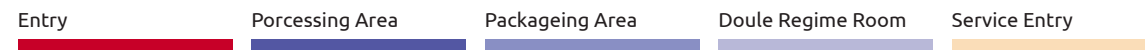

BASEMENT FLOOR PLAN



BASEMENT FLOOR PLAN

UNIT	FUNCTION	AREA	DIMENSIONS	TEMP.
BSM-DR1	DOUBLE REGIME ROOM	98 m ²	8.89W x 11.12L x 6H	±0 °C / -20°C
BSM-DR2	DOUBLE REGIME ROOM	98 m ²	8.89W x 11.05L x 6H	±0 °C / -20°C
BSM-DR3	DOUBLE REGIME ROOM	88 m ²	8.89W x 9.90L x 6H	±0 °C / -20°C
BSM-DR4	DOUBLE REGIME ROOM	88 m ²	8.89W x 9.90L x 6H	±0 °C / -20°C
BSM-DR5	DOUBLE REGIME ROOM	68 m ²	8.89W x 7.68L x 6H	±0 °C / -20°C
BSM-DR6	DOUBLE REGIME ROOM	68 m ²	8.89W x 7.75L x 6H	±0 °C / -20°C
BSM-DR7	DOUBLE REGIME ROOM	118 m ²	8.88W x 13.28L x 6H	±0 °C / -20°C
BSM-DR8	DOUBLE REGIME ROOM	118 m ²	8.88W x 13.27L x 6H	±0 °C / -20°C
BSM-DR9	DOUBLE REGIME ROOM	125 m ²	8.88W x 14.05L x 6H	±0 °C / -20°C
BSM-DR10	DOUBLE REGIME ROOM	70 m ²	8.88W x 7.95L x 6H	±0 °C / -20°C
BSM-DR11	DOUBLE REGIME ROOM	80 m ²	8.88W x 7.95L x 6H	±0 °C / -20°C
BSM-DR12	DOUBLE REGIME ROOM	65 m ²	8.14W x 8.05L x 6H	±0 °C / -20°C
BSM-DR13	DOUBLE REGIME ROOM	65 m ²	8.04W x 8.05L x 6H	±0 °C / -20°C
BSM-PR14	PEANUT ROOM	52 m ²	9.45W x 5.53L x 3H	±0 °C / +4°C
BSM-PR16	PROCESSING AREA	680 m ²	24.63W x 33.26L x 6H	+20°C
BSM-PR17	PACKAGING AREA	200 m ²	24.63W x 8.80L x 4.5H	+10°C
BSM-LA18	LOADING AREA	200 m ²	4.5H	+10°C

Plan Legend:

